

Installing your RVpaws with Equalizer Leveling System

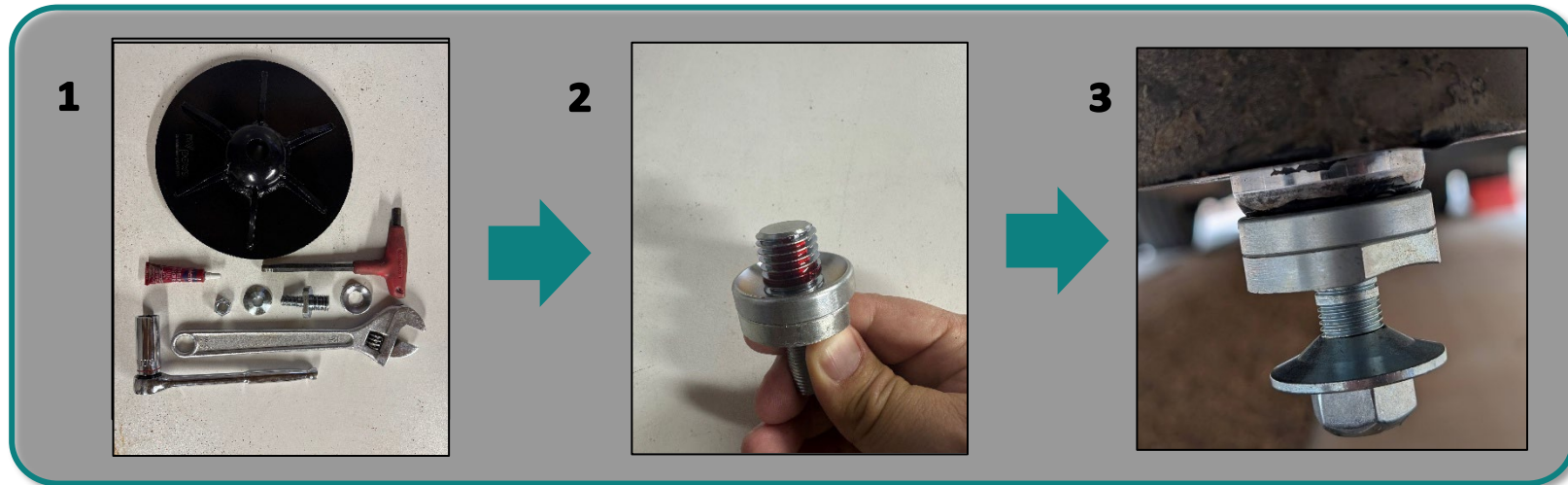

Tools Needed: An open-faced adjustable wrench, a socket wrench with a 19mm socket, a ½" Allen / Hex key
Red "permanent" thread lock liquid.

Start by removing the existing feet using the ½" Hex / Allen Key. Some remove easily while others require that you fully retract the hydraulic ram to create some extra friction. If this still doesn't work, an impact key in reverse should help loosen the bolt.



Step 1

- Installation Kit – for each RVpaw purchased you will receive 1 foot, 1 ankle, 1 conical washer, 1 concave washer and 1 lock nut. Lay these out ready to use along with the tools noted above.

Step 2

- Start by putting on the concave washer onto the side of the ankle with the larger threads. Coat the large threads with Red thread lock. See figure 2.
- **DO NOT OMIT THIS STEP! –Failure to apply lock thread could result in the foot becoming detached in transit, potentially causing serious damage.**

Step 3

- With then ram fully and freshly retracted, screw the ankle assembly up into the bottom of the hydraulic ram. See figure 3.
- Use the open-faced wrench to get the ankle as tight as you can to the ram. At some point the Ram will start to turn – this is normal, and the reason we use red thread lock to keep the ankle from coming loose.
- Once the thread lock has set, it will hold the threads in place.

CONTINUED ON PAGE 2

Installing your RVPaws with Equalizer Leveling System continued



Complete steps 1 through 3 on page 1 before continuing.

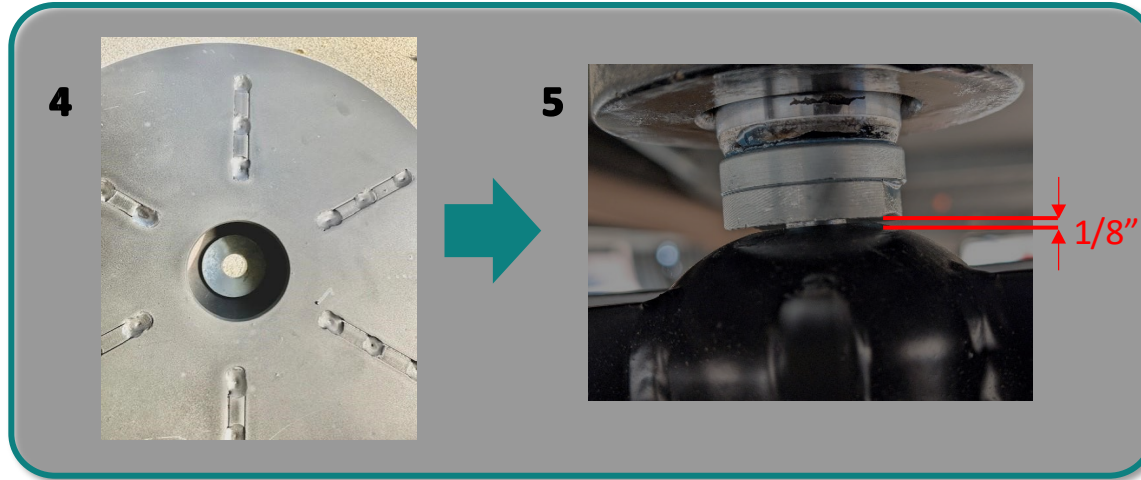

Step 4

- Remove the conical washer and lock nut from the ankle assembly. Turn the foot dome side-down and drop in the conical washer with the cone side-down (the flat side of the conical washer should be facing you). See figure 4.
- Flip over the assembly keeping the tips of your fingers in the dome hole to hold the washer in place.
- Offer up the assembly to the ankle allowing the threads to pass through the dome and the conical washer.
- With your other hand, screw the lock nut onto the assembly and tighten until you feel resistance.

Step 5

- Tighten the nut onto the ankle using the 19mm socket. If the whole ram starts to turn, use the open-faced wrench on the ankle to stop it turning.
- **Do not tighten it all the way!** You need to leave an approximately 1/8" gap between the top of the dome (Figure 5) and its mating surface of the ankle. This allows the foot to articulate to meet the contours of the ground.
- Wiggle the foot – it should be able to rotate freely and should be able to articulate in any direction up to about 10 degrees without jamming. If it jams, loosen the lock nut a quarter turn until it no longer jams.

Test your installation by lowering and raising the jacks. If the foot is still at an articulated angle when retracted, don't worry! The conical washer along with the vibrations of the coach moving down the road, will self-center the foot in short time – another great feature of the RVPaw!

NOTE: If you are in any doubt whatsoever about the installation process, email: info@rv-paws.com for assistance or seek the help of a professional mechanic to complete the installation. **RVpaws is not responsible for any damage or injury resulting from an installation that does not fully conform to these instructions.**



Using your new RVpaws

Congratulations on purchasing and installing your new RVpaws. By now you'll agree, these are a superior upgrade in strength and in functionality. They articulate to meet the contours of the ground, reducing stresses on your chassis and hydraulic system. RVpaws are seriously strong and will be a permanent installation for the life of your coach!

With that in mind, there are a few things that are your responsibility.

1. **Before you lower the feet:** Make sure the feet will land on a firm and flat surface. Be sure to get out and visually check the landing zone for all 4 feet ensuring there are no holes in the ground or obstacles such as large rocks, curbs, logs, etc., that will over-extend the ankle.
2. Lower the feet and level the RV:
 - Always ensure the park break is firmly on!
 - Never let the tires leave the ground – this puts enormous lateral stresses on your chassis and hydraulic system which could cause damage. If necessary, drive onto blocks to support the tires.
 - If needed, use blocks under the RVpaws. TIP: the more you extend the hydraulic rams, the more they are susceptible to lateral movement which in turn makes the coach feel like it's moving when up on the leveling jacks. Simply stated, the hydraulic rams are great at applying vertical pressure, they are not so great at stopping lateral movement - the less they are extended, the more leverage they have and the more solid your coach will feel.
3. **The RVpaw V2 ankle has a unique break away feature: If the RVpaw is inadvertently lowered into a hole or onto an obstacle such as a curb, large rock, or a log, the ankle may be forced into an overextended position. Because the RVpaw is so strong and will not bend, the ankle is designed to detach the RVpaw to help protect the hydraulic ram and chassis.** This is in preference to bending a ram which will cost a lot more to replace than an ankle. Given the number of ways such a scenario could happen, **RVpaws is not liable for any damage incurred to your hydraulic system or coach.** Again, to avoid this happening, always check the ground for obstacles and holes before lowering your leveling jacks. If you do break an ankle, you can get a replacement from [RVpaws](https://rvpaws.com). Because sometimes you can never be 100% sure, we strongly recommend that you keep a spare ankle in the coach.
4. Before you leave the campsite, retract the gear and walk around performing a quick visual inspection to make sure all feet are up and attached.
5. If the feet retract at an angle (articulated) don't worry, the conical washer along with the vibrations from the coach going down the road will soon recenter the foot – another great feature of RVpaws!

Like you, this family run business consists of avid campers! We are constantly in the pursuit of making this experience as good as it can be. When we created RVpaws, we knew we were one step closer to a great experience - we hope you agree!

We hope you will enjoy life on a firm footing with many years of trouble-free service from your new RVpaws!

NOTE: If you are in any doubt whatsoever about the correct usage of RVpaws, email: info@rv-paws.com for assistance. **RVpaws is not responsible for any damage or injury resulting from incorrect use of our products.**